

# Master bedroom

Layout and wardrobes

Prepared for xxx

*becky hirt*  
INTERIORS

# The Brief

Suggest one or more layouts for the bedroom, enabling you to confirm the position of any fitted wardrobes.

Source wardrobes; budget should be in the range of £4k to £8k, and the look and feel should be in keeping with the guest room bed, bedside tables and lamps, which will stay.

# Layout

Bed positioned further towards front window to maximise space in seating area

Position of seating area makes the most of the view from the window and the light

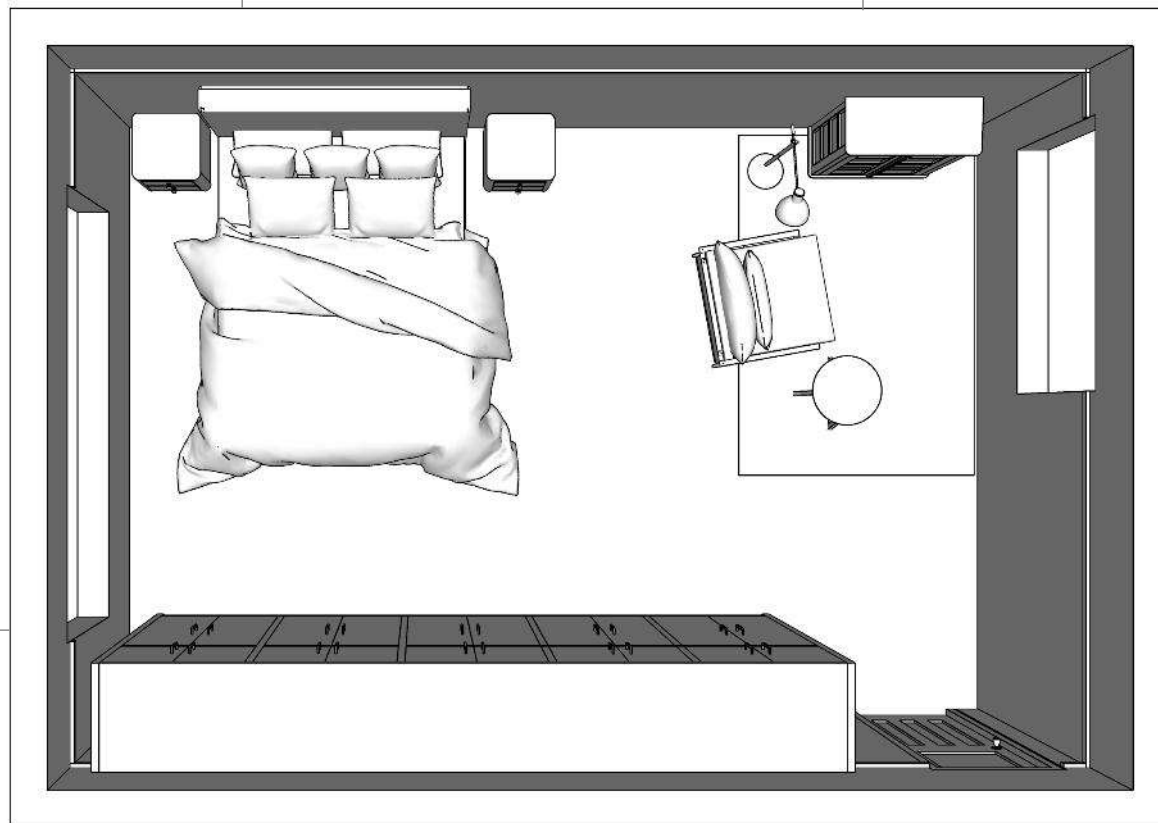

This layout features a single lounge chair

Wardrobes positioned on door wall to maximise wall space; if placed on opposite wall they would obstruct the garden facing window

# Layout

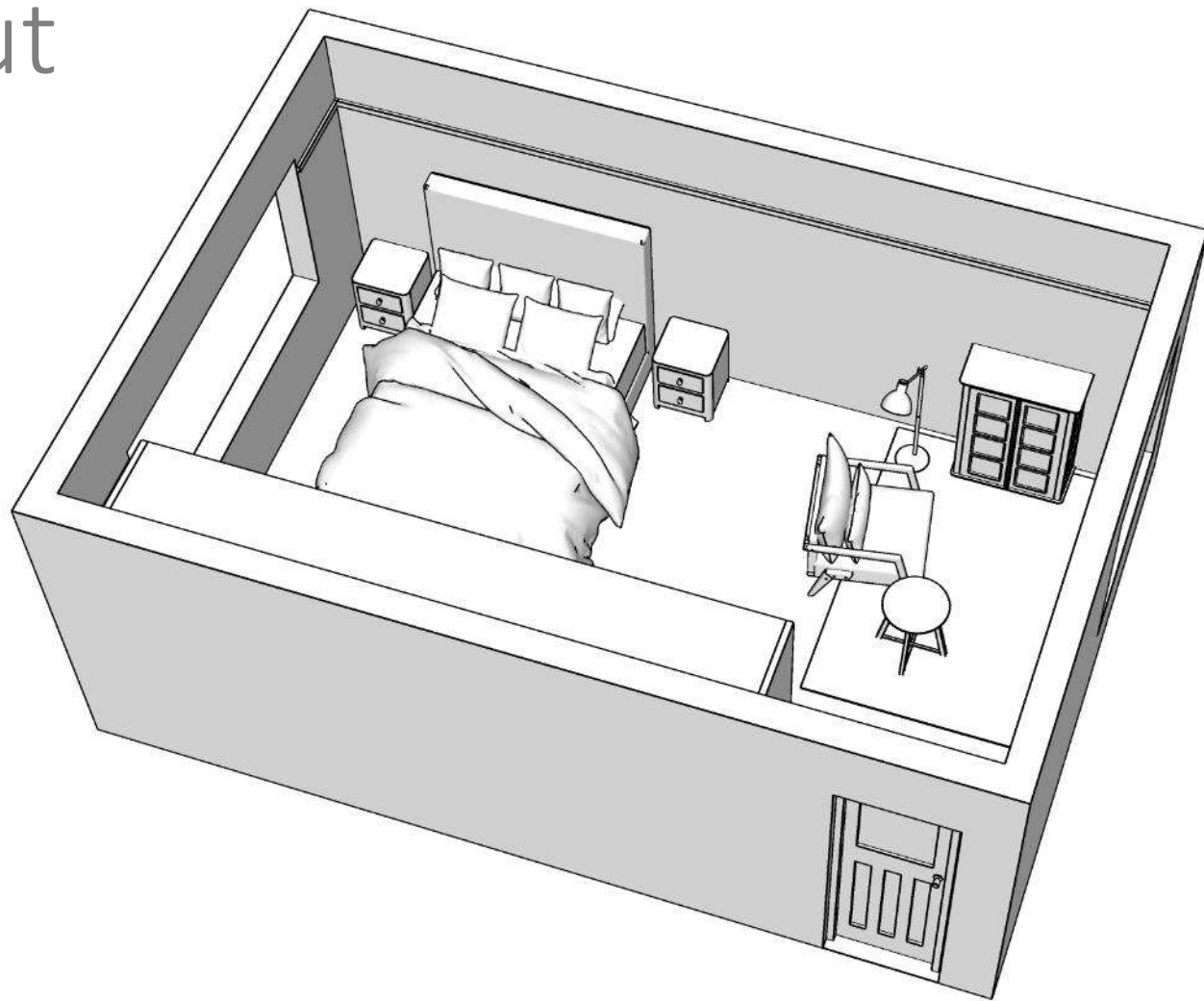

# Layout

Picture rail may need to be removed on wardrobe wall to facilitate fitting of wardrobes flush to wall

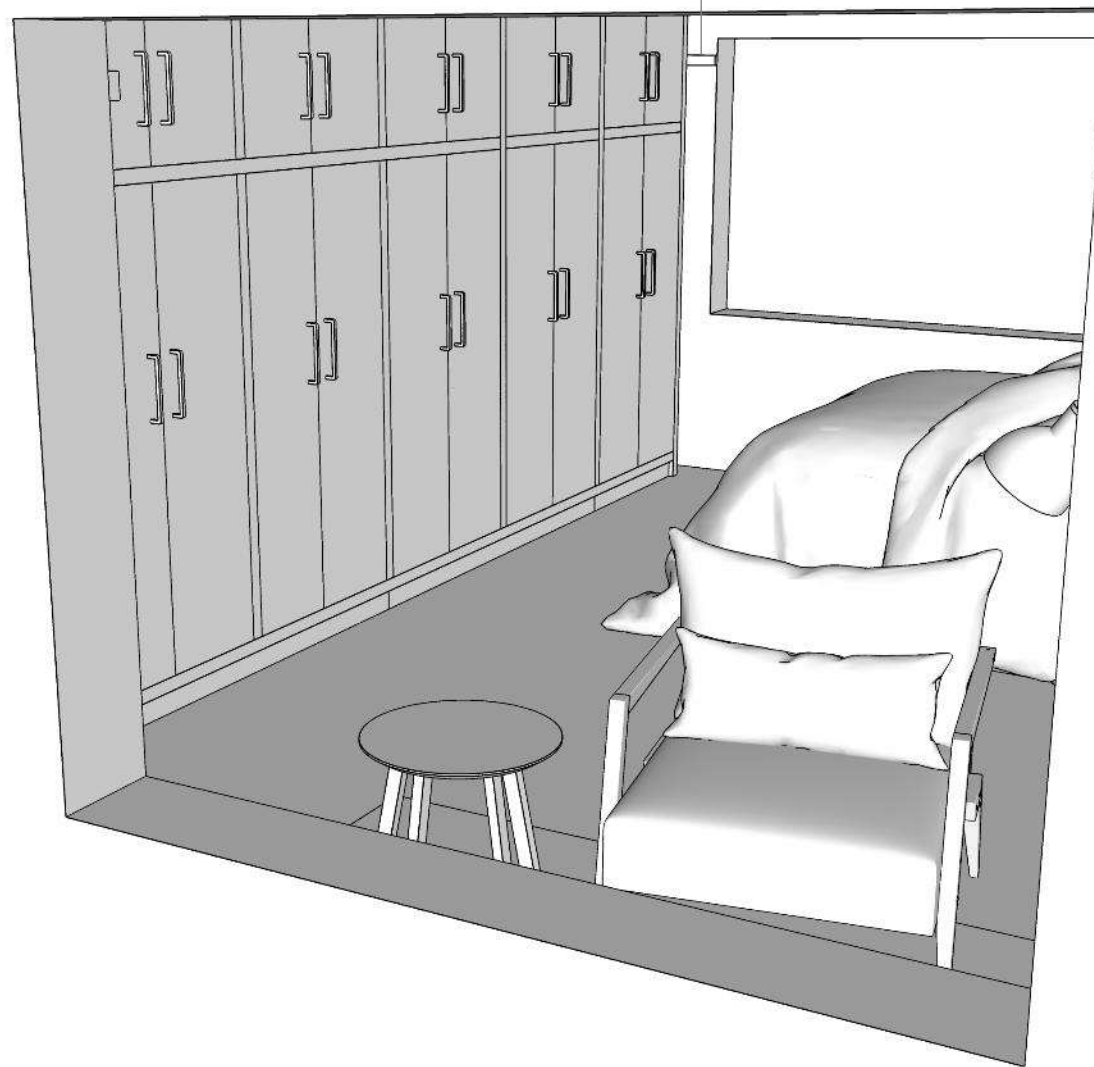

# Layout

This layout features a love seat, which still leaves plenty of room for access

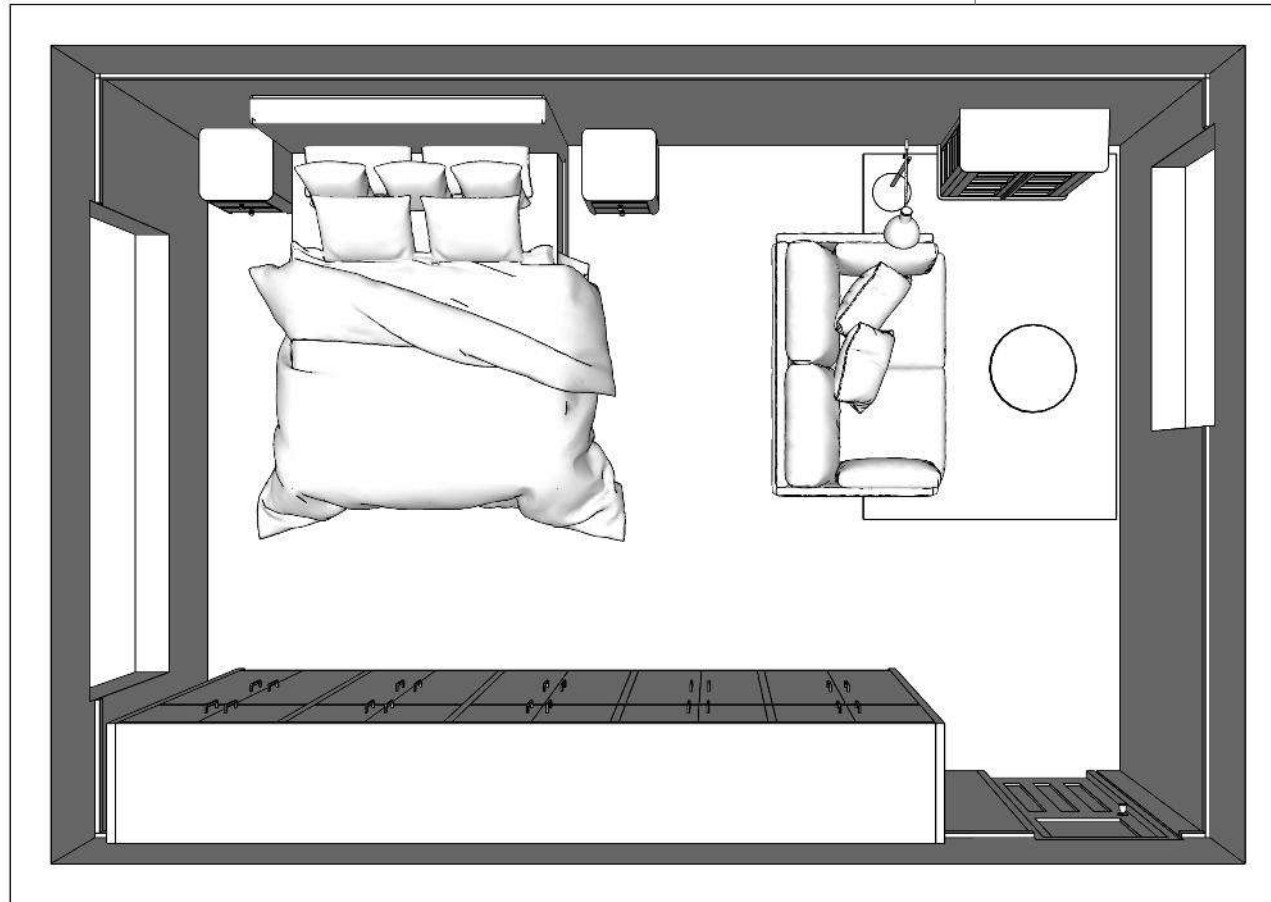

# Wardrobes

Look and feel should be in keeping with the guest room bed, bedside tables and lamps, which will stay.

Rug may also be used. Book cabinet from downstairs may be moved up to the bedroom.

You expressed an interest in Tylko, which has a contemporary, minimal style.

Clean but rounded lines will link to the furniture already there and allow the detail of the period pieces (eg rug and bookcase) to shine.

# Visual references





# Proposed wardrobe style

CLEAN AND CONTEMPORARY BUT WITH A NOD TO SCANDI AND MID-CENTURY DESIGN



Wooden handle reveal can be matched to existing wood in the room



Curved shape of opening mimics shapes in existing furniture and softens hard lines of wardrobe



Integrated wooden handles provide visual interest and tie wardrobes into existing furniture and furnishings



Colour can be matched to bookcase or you could go for a neutral



**URBAN**  
WARDROBES

*becky hirt*  
INTERIORS

# Specifics

4-5 weeks' lead time

Approximate cost of around  
£6,000 + VAT including  
installation (subject to final  
design and site visit)



**URBAN**  
WARDROBES



*becky hirt*  
INTERIORS

# Living room

Layout and design concept

*becky hirt*  
INTERIORS

# The Brief

Create a feeling of cosiness and flow.

Suggest one or more layouts for the room.

Create a look and feel which incorporates the existing rug and suggests some possible furniture types/items.

Recommend some plants and curtains.

# The Layouts

Three layouts explored here.

Different elements of the layouts can be combined.

Furniture has been selected to show placement – details can be decided later.

Window treatment (eg blinds, curtains) left out for now as this will be affected by layout.

Only one layout includes plants and lighting at this stage, but these details can be added to your preferred option.

# Layout 1

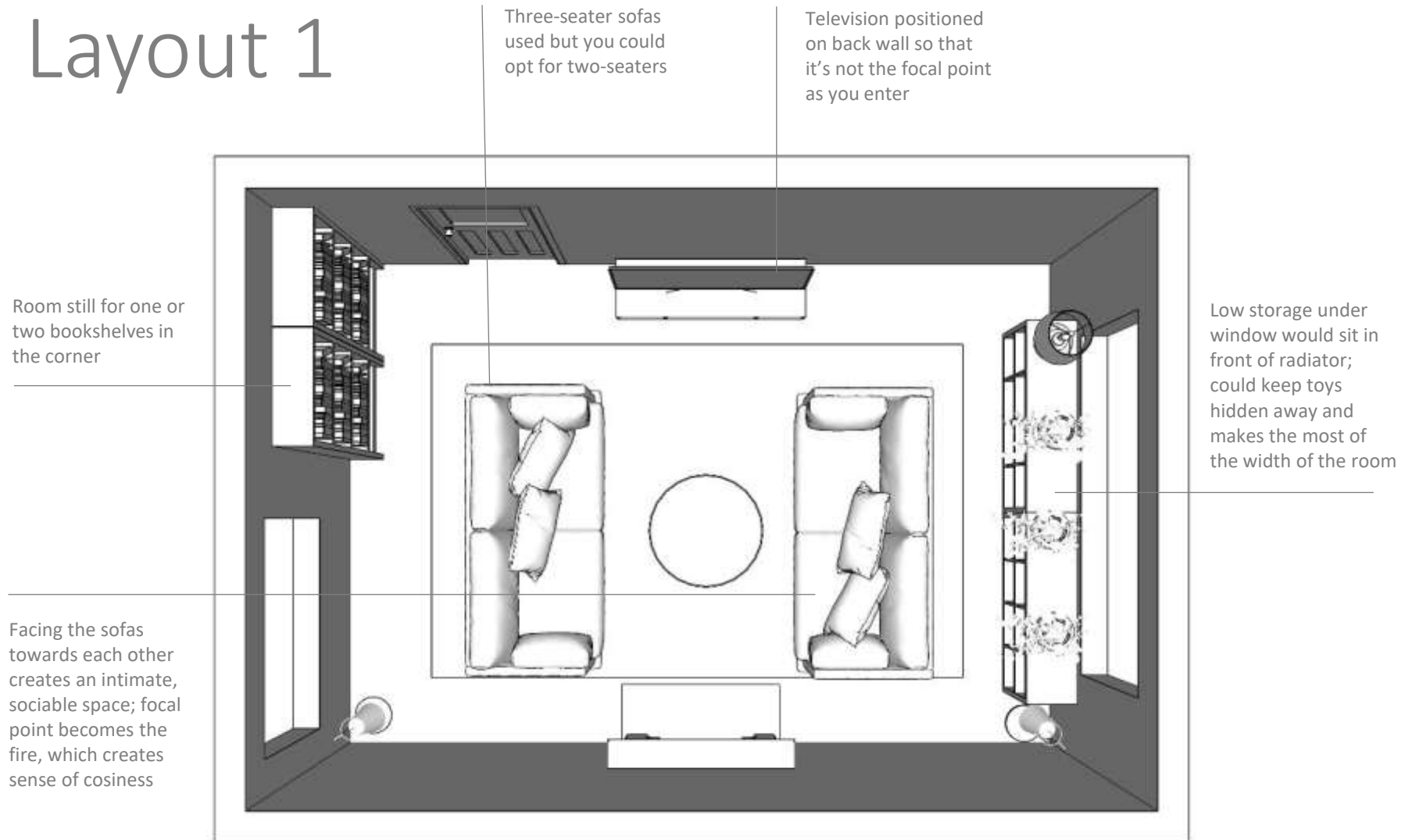

# Layout 1

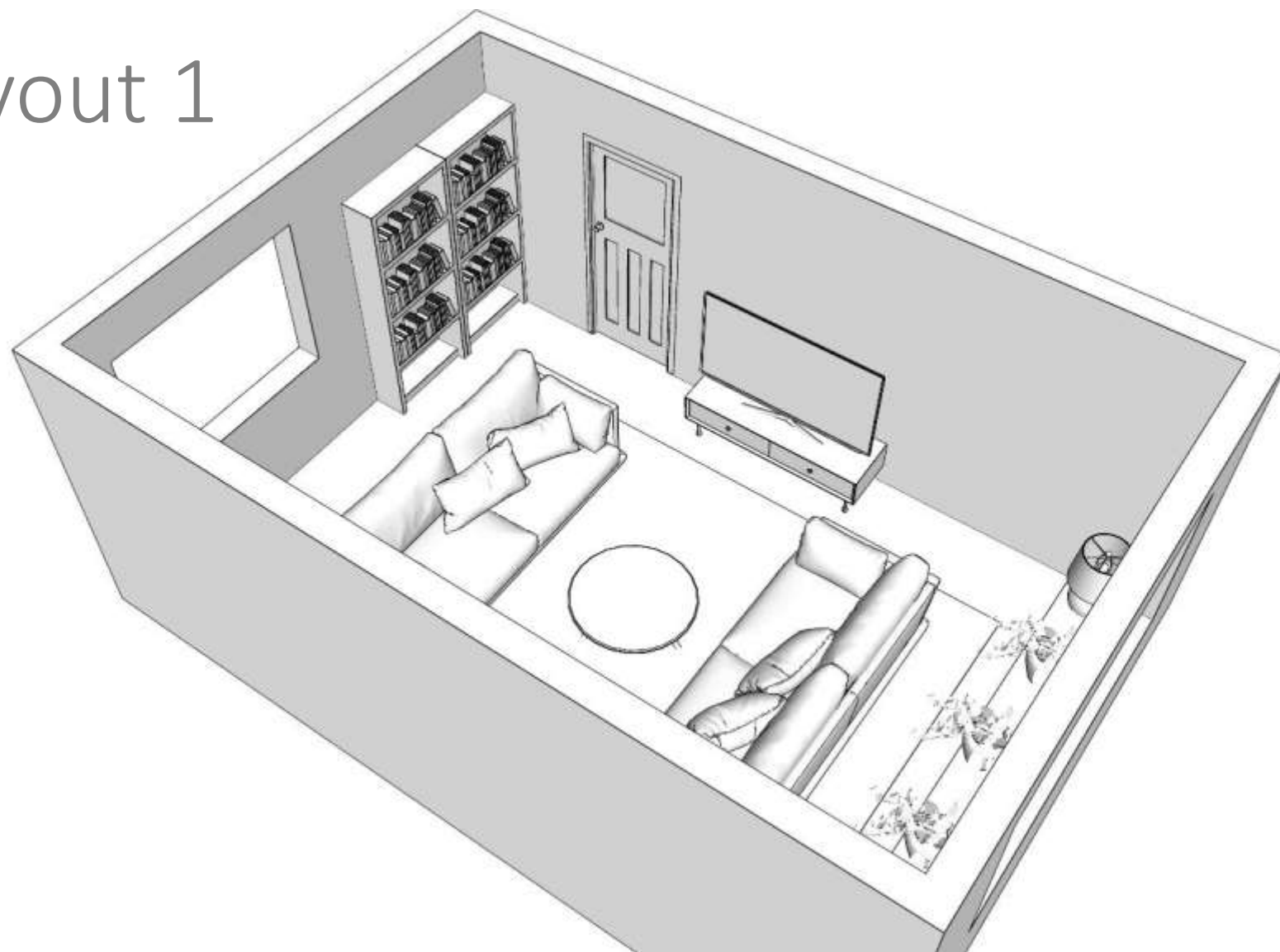

# Layout 1

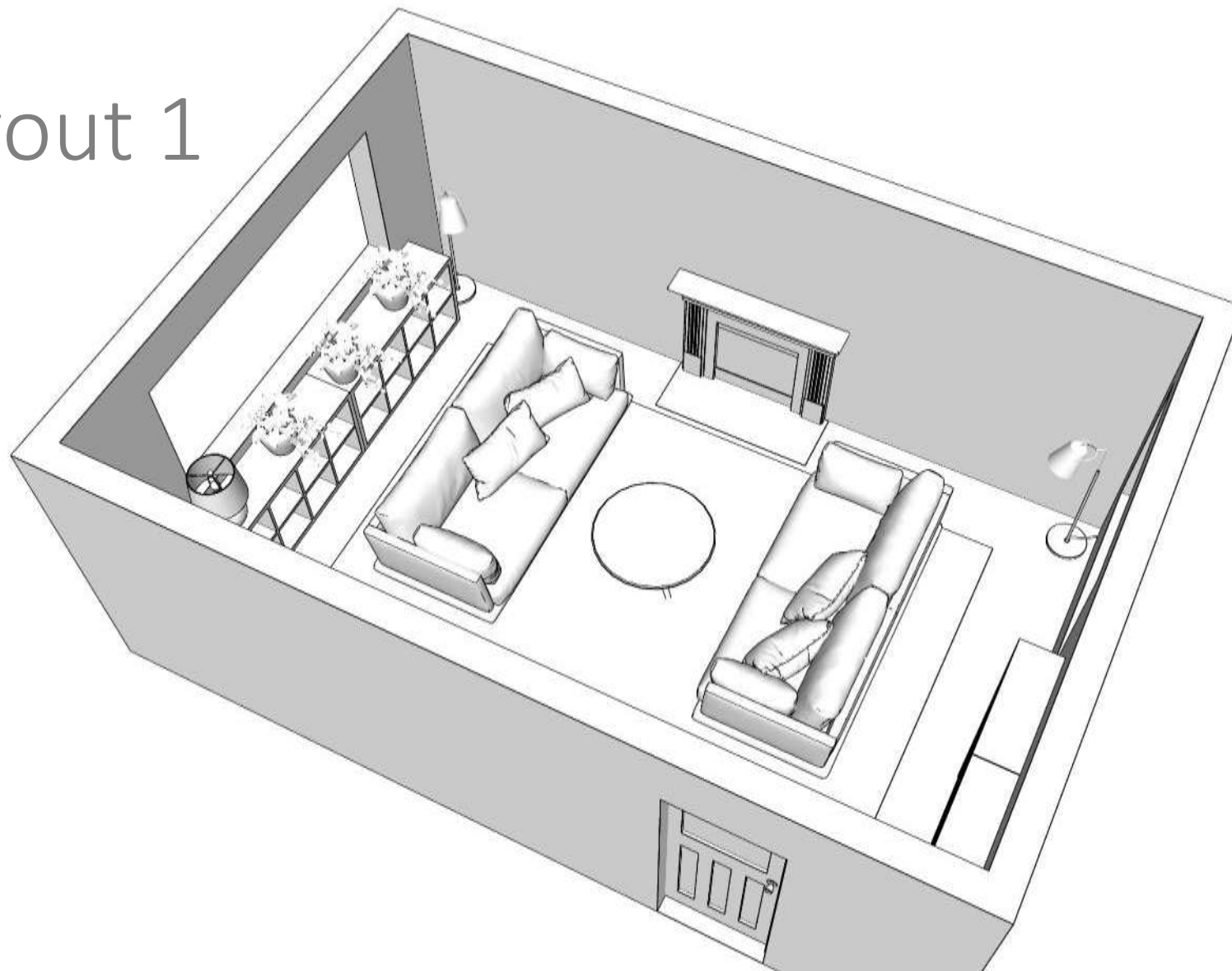



# Layout 2

Television positioned on front wall so that it becomes the focal point as well as the fire

Seating facing inwards creates intimate, cosy space

Using only one sofa means space is less dominated by furniture; layout is flexible as lounge chairs can be angled towards television

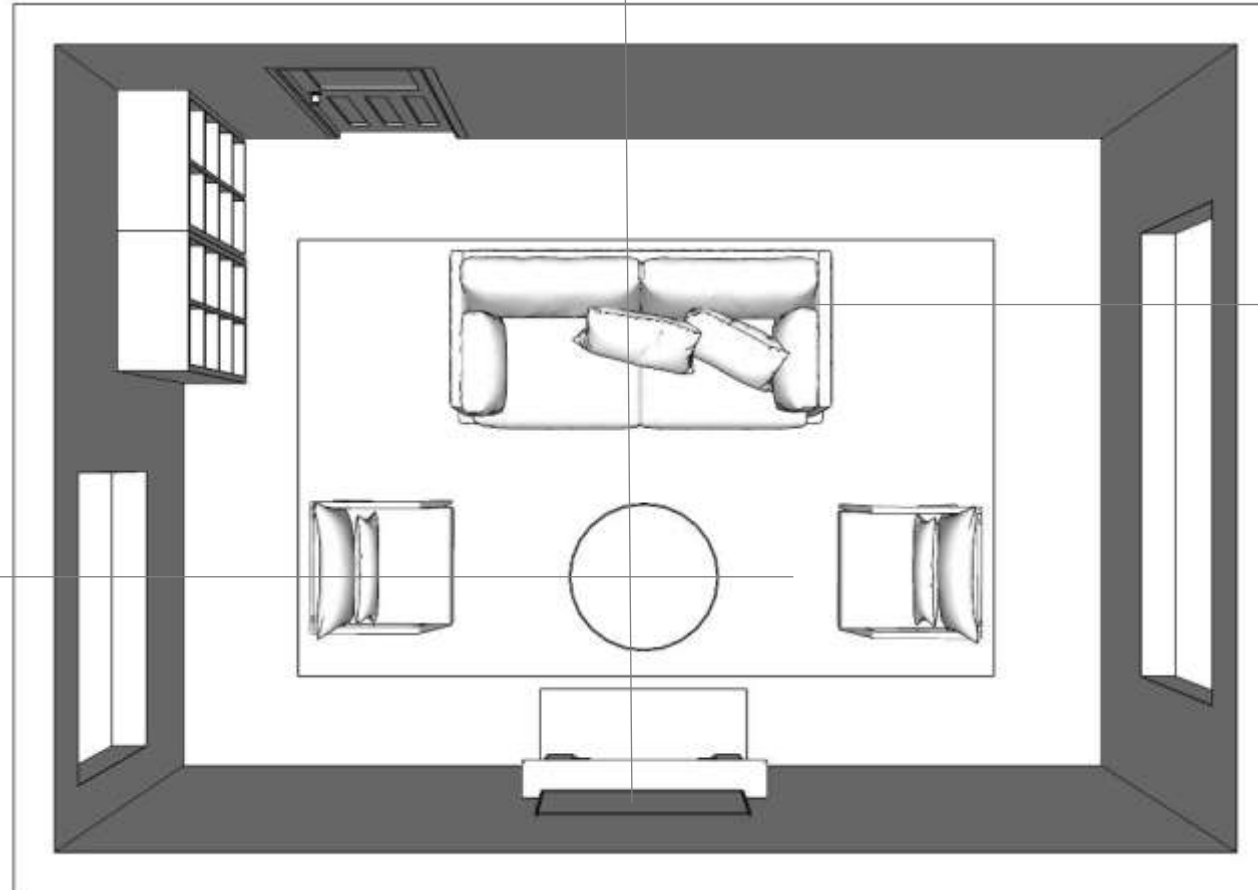

# Layout 2

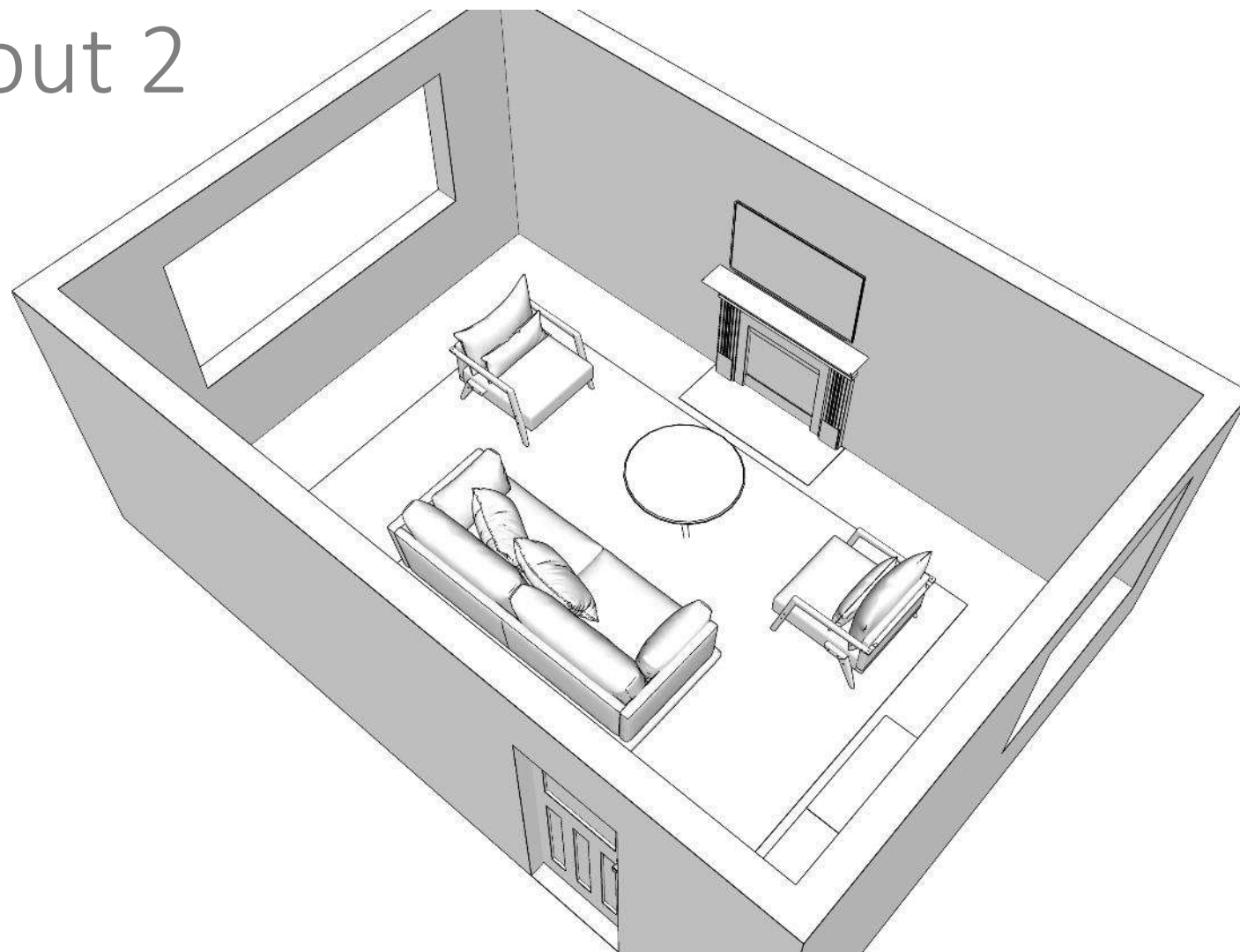

# Layout 3

Corner sofa creates cosiness and is placed so that it faces the window over the back garden, where the light and views come from towards the end of the day

This layout enables both sociability and TV watching, and creates flow from the door through the space

This layout creates more of a sense of openness on one side and this helps to reduce focus on the television

The lounge chair can be moved into the corner to open out this side of the room, or to enable someone to sit by the window; moving the lounge chair to the corner also creates space for the girls to play

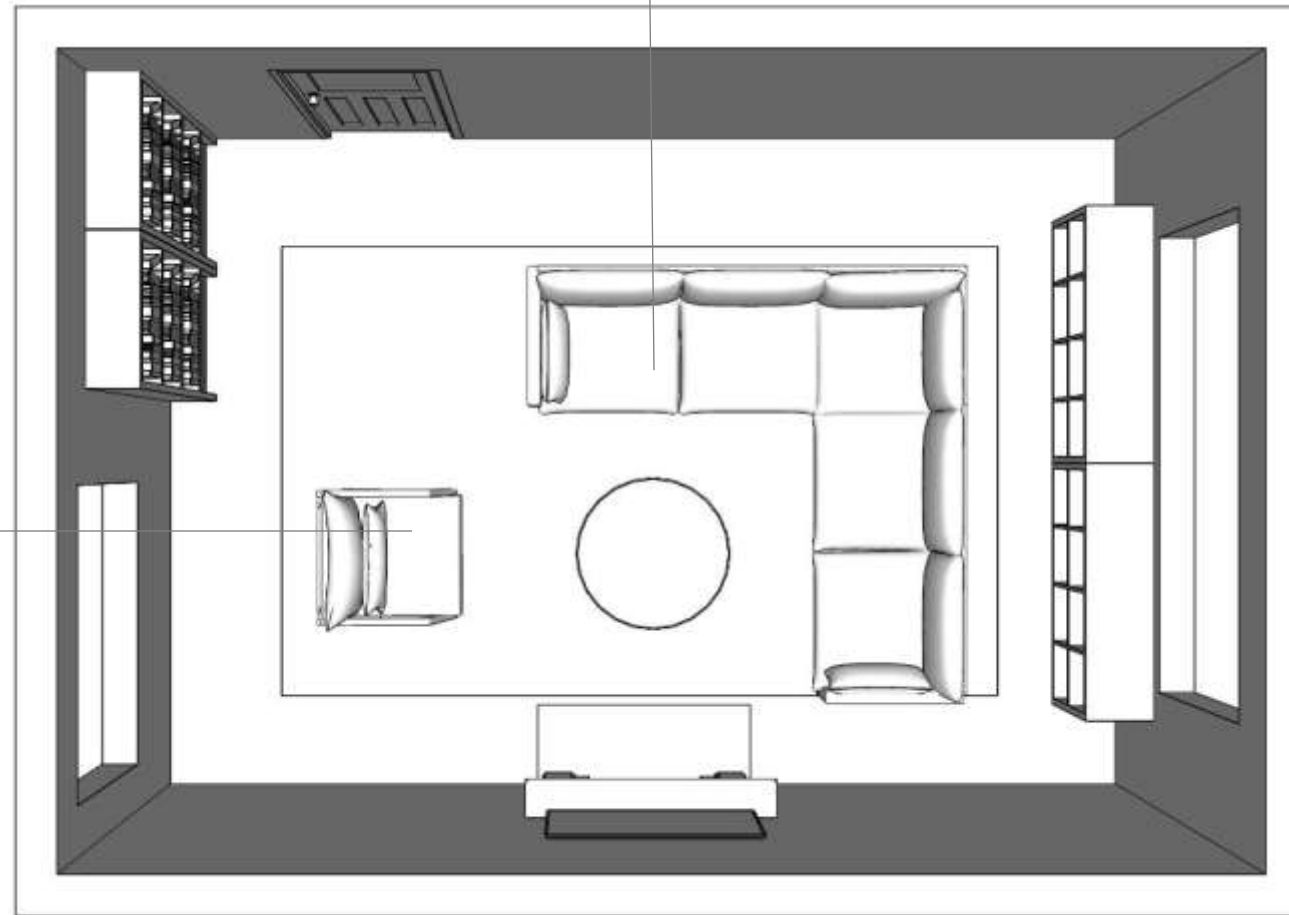

# Layout 3

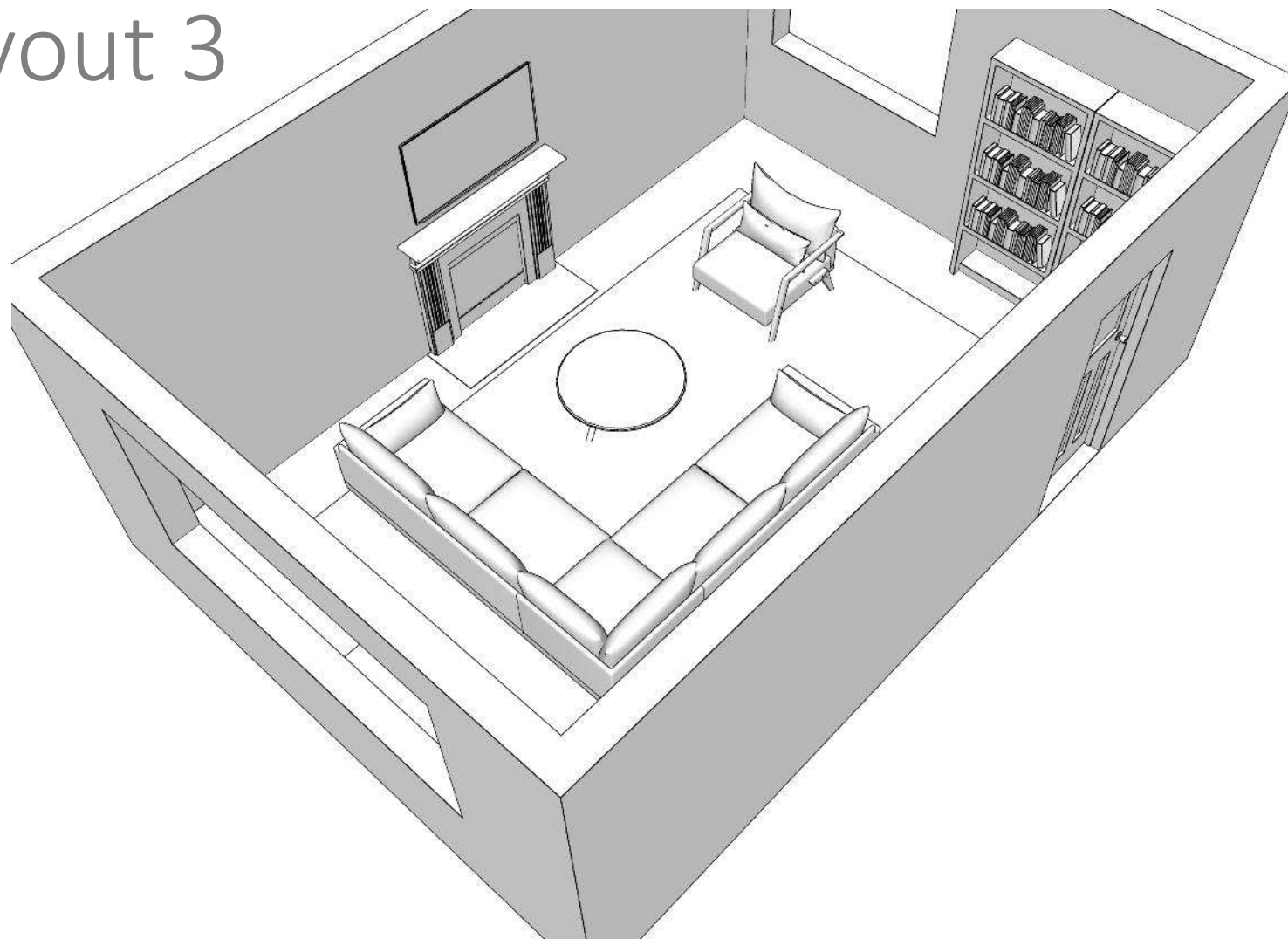

# Inspiration

Takes into account the period of your house and your stylistic preferences

Rich rusts and warm terracottas

Some curved, flowing shapes, combined with clean, crisp lines

Subtle blend of old and new

A mixture of textures, including wool, velvet and wood

Walls can be terracotta, as previously discussed; seating a mixture of rust and neutral/accent colours

Blue and green accents, flashes of brass





# Specifics



# Curtains/blinds

Depends a little bit on final choice of layout and storage/furniture

Key goals: create sense of ceiling height; create cosiness and warmth; create privacy at front of house

Hang the curtains on the back window close to the ceiling and pool the curtains on the floor

Front window could have recessed curtains or wooden blinds



# Plants

If you aren't used to looking after plants, don't go for too many

One or two large floor plants might be a good start

Both windows have radiators under them, so exposing the plants to light will also mean they are near the heat

So they need to be resilient

Best to finalise plant choice once you have signed off the layout – position of plants is affected by position of furniture and plant position dictates plant selection

The selection here is child friendly (non-toxic)



KENTIA PALM  
90cm – 180cm  
light watering  
medium light  
mist a couple of times a week



CHINESE MONEY PLANT  
10cm – 20cm  
light watering  
medium light



ASPIDISTRA  
40cm – 100cm  
light watering  
most light conditions  
spray every few days